

Bevi 2.0 Standup



Filter Flush Valve Retrofit Installation

Parts Required

Standup 2.0 Filter Flush Valve Retrofit Kit
(Bevi Part Number 720-0132)

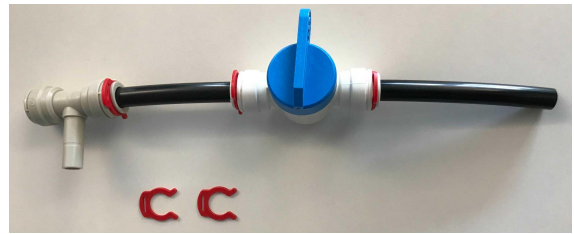

Installation Instructions

NOTE: *If you are using this kit as part of a new Standup 2.0 installation, skip to step 5.*

1. Turn off source water to the machine.
2. Enter the **Service Panel** to open the door and go to **Machine Alerts > Troubleshooting Tools**.
3. **Close the Buffer Tank** by reaching through the slot above the filter and turning the blue valve handle 90-degrees clockwise.

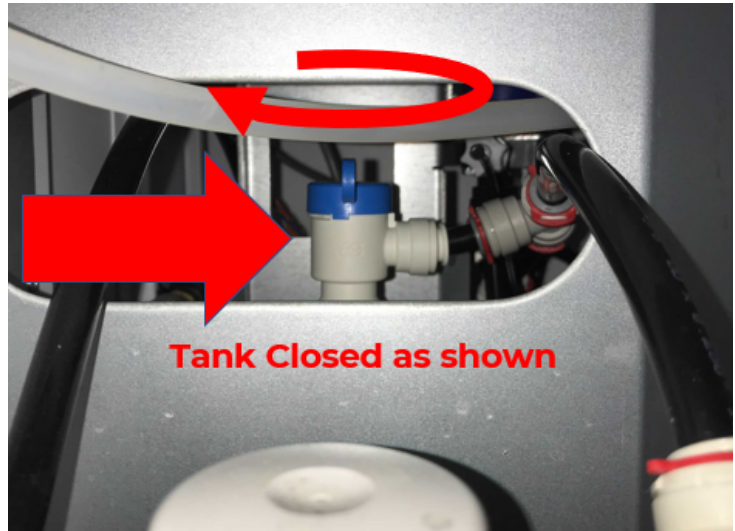

4. Place an empty bucket under the nozzle. In Troubleshooting Tools, **dispense STILL** water for 2 seconds to relieve internal pressure in the lines.
5. Remove the 2 red clips and push-to-connect-to-stem elbow fitting on the right / outlet side of the filter head

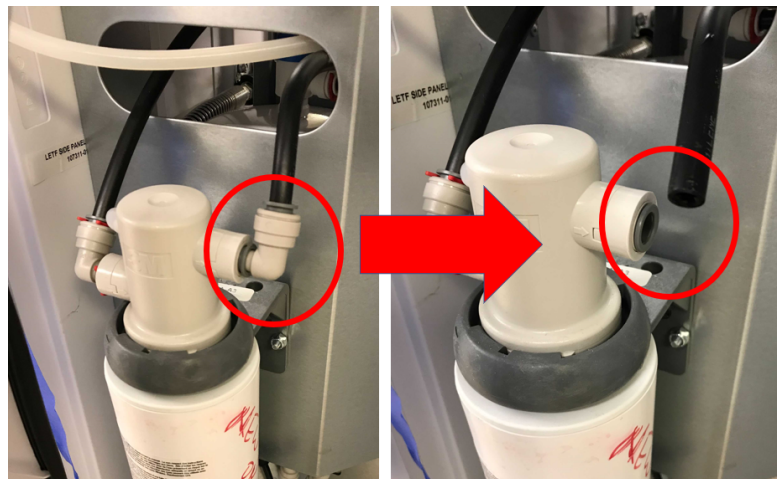

6. **Install the Filter Flush Valve** by inserting the stem of the tee fitting into the right / outlet side of the filter head. Insert the hanging $\frac{3}{8}$ " tube into the open push-to-connect on the tee fitting. **Ensure both connections are fully seated.** Add red locking clips to the 2 connections.
7. **Ensure that the Filter Flush Valve is OFF.** The blue valve handle should be perpendicular to the tubing.

NOTE: *If you are adding this kit as part of a new Standup 2.0 installation, skip ahead to **step 13**.*



8. **Open the Buffer Tank** by reaching through the slot above the filter and turning the blue valve handle 90-degrees counterclockwise.



9. Turn on source water to the machine.
10. **Test Fittings.** Place an empty bucket under the nozzle. In **Troubleshooting Tools**, dispense **STILL** water to fill the water system. Check for leaks at the Filter Flush Valve and fittings.
11. **Bleed Air.** Place an empty bucket under the open tube beneath the Filter Flush Valve. Open the Filter Flush Valve for 3 seconds to remove any trapped air. Close the Filter Flush Valve.
12. **Flush System.** Place an empty bucket under the nozzle. In **Troubleshooting Tools**, dispense at **least 1/2 gallon of STILL** water to ensure no air remains in the system.
13. **When complete, you must call Bevi Tech Support (866-704-2384)** to confirm that the Filter Flush Valve kit has been retrofitted on this Standup 2.0.