

Replacing Flavors in a Countertop Bevi

Flavor swaps must be logged in the Service Panel on the Bevi touchscreen to ensure proper tracking of expiration dates and inventory.

1. Access the Service Panel

Select **Ingredients** at the bottom of the touchscreen.



Select **any flavor** or **Pure Water**.



Select & hold upper right **X**, until you see **Service Panel Loading**

2. Start Service

Select the **Start Service** button at the upper right-hand corner.



Flavors that need to be **Restocked** are highlighted in red.



If a flavor does not require an update, select **No Action**.

3. Open the bottom cabinet doors

Locate **Flavors** to be replaced, as indicated in Service Panel.



4. Disconnect the Flavor Connector and discard old boxes

For green Encore connectors, rotate counter-clockwise, until disengaged. Slide off the connector.

For gray QCD connectors, push on tabs and pull until the connector fully disengages.

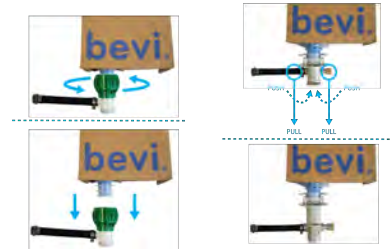

5. Open new flavor boxes and remove the cap.



6. Insert new Flavors

Insert new flavor boxes into the bottom cabinet area and **reconnect** connectors as you did in Step 4.



6. Update Flavors in Service Panel

Return to Service Panel, select **Restock** for any replaced flavors.



Type the **Two-Digit ID** printed on the Flavor Box and select the corresponding flavor.



7. Prime and End Service

Place a vessel in the dispense area. Press then hold **Prime for 15 seconds** to push the new flavor through each flavor line to prevent crossover.



Select **End Service**. **Close the bottom cabinets**.

